

# Series F



# Series F

## Technical features

**Bright nickel plated steel cup and die-cast arm.**  
**Dimensions of the Ø 40 mm cup.**

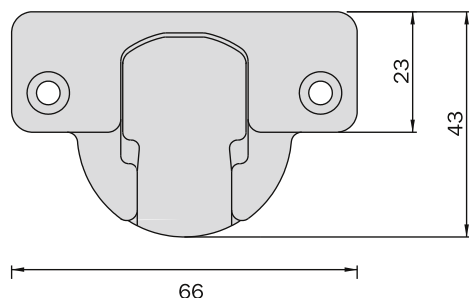

Constant «L» value of 0,7 mm (it does not change during side adjustment)

Approx. number of hinges required according to the door dimension and weight.

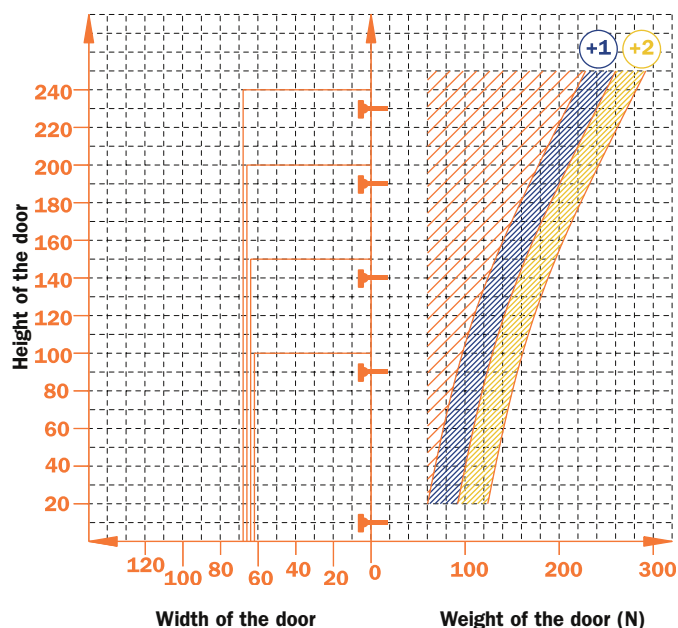

## Adjustments

Compensated side adjustment from -0,5 mm to +5,5 mm

Height adjustment  $\pm 2$  mm

Depth adjustment with Series 200 mounting plates +2,8 mm

Depth adjustment with DOMI® mounting plates from -0,5 mm to +2,8 mm

## Mounting plates

Symmetrical and asymmetrical bright nickel plated steel or die-cast Series 200 mounting plates



Snap-on assembly on DOMI® mounting plates

Positioning with pre-determined stop on traditional Series 200 mounting plates

N.B. : Use POZIDRIVE No. 2 screwdrivers for all screws

# Series F

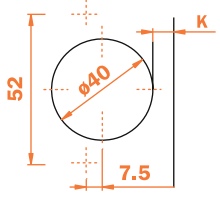
## Drillings and fixings

						
		94°	110°	120°	165°	
Wood screw		A				

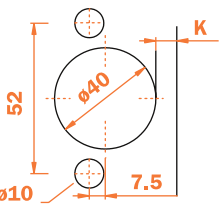
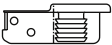
						
		94°	110°	120°	165°	
Dowel		B				

Use this table to identify the available drillings and fixings. Fill the third position of the hinge code number with the letter or the number corresponding to your choice. I.e.: CF...7A99

Fill this position with the chosen letter or number.

# Series F 94°



## Technical information

For profile and thick doors (up to 40 mm)

13 mm deep steel cup

40 mm cup diameter

94° opening

Possible drilling distance on the door (K): from 3 to 15 mm

Compatible with all traditional Series 200 mounting plates and with all DOMI® snap-on mounting plates

## Space needed to open the door

T=	20	21	22	23	24	25	26	27	28	29	30	31	32	33	34	35	36	37	38	39	40	L=
K=3 A=	0,4	0,5	0,7	0,8	1,0	1,2	1,4	1,6	1,9	2,2	2,5	2,8	3,1	3,5	4,1	5,0	6,0	6,9	7,8	8,8	9,7	0,0
K=4 A=	0,4	0,5	0,7	0,8	1,0	1,2	1,4	1,6	1,9	2,1	2,4	2,7	3,0	3,4	3,8	4,4	5,3	6,3	7,2	8,1	9,0	0,0
K=5 A=	0,4	0,5	0,6	0,8	1,0	1,2	1,4	1,6	1,8	2,1	2,4	2,7	3,0	3,3	3,7	4,1	4,8	5,7	6,6	7,5	8,4	0,0
K=6 A=	0,4	0,5	0,6	0,8	0,9	1,1	1,3	1,6	1,8	2,1	2,3	2,6	2,9	3,3	3,6	4,0	4,4	5,2	6,0	6,9	7,8	0,0
K=7 A=	0,4	0,5	0,6	0,8	0,9	1,1	1,3	1,5	1,8	2,0	2,3	2,6	2,9	3,2	3,6	3,9	4,3	4,8	5,5	6,4	7,3	0,0
K=8 A=	0,4	0,5	0,6	0,8	0,9	1,1	1,3	1,5	1,7	2,0	2,2	2,5	2,8	3,1	3,5	3,8	4,2	4,7	5,1	5,9	6,8	0,0
K=9 A=	0,4	0,5	0,6	0,7	0,9	1,1	1,3	1,5	1,7	2,0	2,2	2,5	2,8	3,1	3,4	3,8	4,2	4,6	5,0	5,5	6,3	0,0
K=10 A=	0,3	0,5	0,6	0,7	0,9	1,1	1,3	1,5	1,7	1,9	2,2	2,4	2,7	3,0	3,4	3,7	4,1	4,5	4,9	5,4	6,0	0,0
K=11 A=	0,3	0,4	0,6	0,7	0,9	1,0	1,2	1,4	1,7	1,9	2,1	2,4	2,7	3,0	3,3	3,6	4,0	4,4	4,8	5,2	5,7	0,0
K=12 A=	0,3	0,4	0,6	0,7	0,9	1,0	1,2	1,4	1,6	1,9	2,1	2,4	2,6	2,9	3,3	3,6	3,9	4,3	4,7	5,1	5,6	0,4
K=13 A=	0,3	0,4	0,5	0,7	0,9	1,0	1,2	1,4	1,6	1,8	2,1	2,3	2,6	2,9	3,2	3,5	3,8	4,2	4,5	4,9	5,4	1,2
K=14 A=	0,3	0,4	0,5	0,7	0,8	1,0	1,2	1,4	1,6	1,8	2,0	2,3	2,6	2,8	3,2	3,5	3,8	4,2	4,5	4,9	5,4	2,2
K=15 A=	0,3	0,4	0,5	0,7	0,8	1,0	1,2	1,4	1,6	1,8	2,0	2,3	2,6	2,8	3,2	3,5	3,8	4,2	4,5	4,9	5,4	3,2

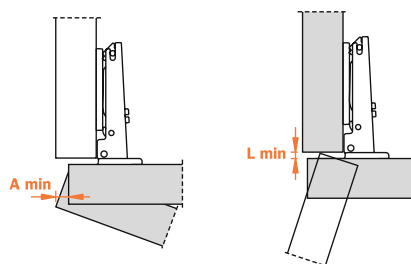

The above values are calculated on the assumption that the doors have square edges. They are reduced if the doors have radiused edges.

## Projection of the door

Projection of the door from the cabinet side at the max. opening. The figures are based on a straight arm hinge, H=0 mm thickness of mounting plate and K value = 3 mm.

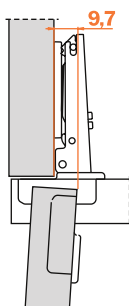

## "C" value

With this formula you can obtain the max. thickness of the moulded door that can be opened without touching adjacent carcase sides, doors or walls, whilst bearing in mind the above L-K-T values.

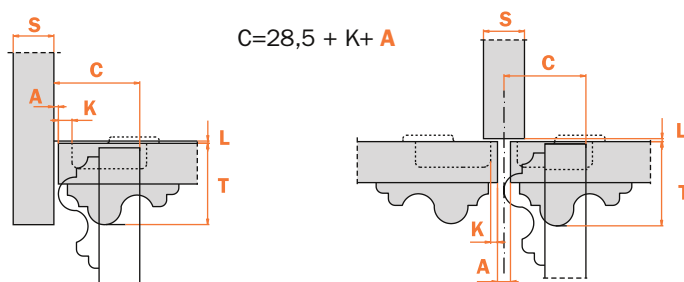

# Series F 94°

## Packing

Boxes 300 pcs.

Pallets 7200 pcs.

**CA** sprung hinge

**CL** unsprung hinge

Use these formulas to determine the type of hinge arm, the drilling distance "K" and the height of the mounting plate "H" which is necessary to solve each application problem.

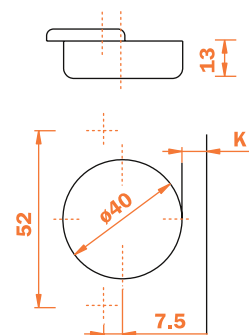

Arm 0

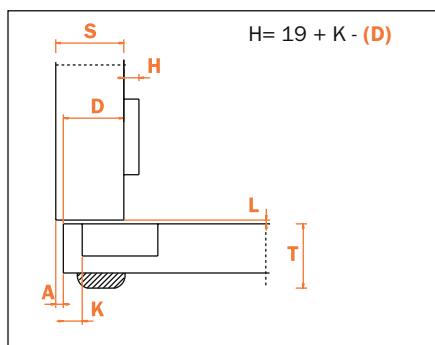

**CA** CF...7A99

**CL** CF...5A99

Arm 11

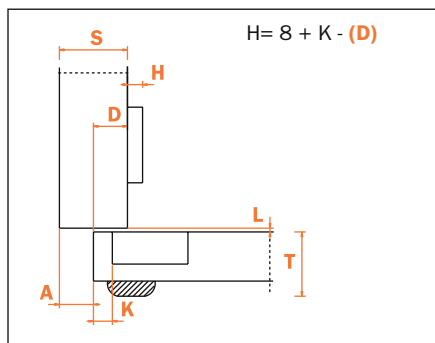

**CA** CF...7G99

**CL** CF...5G99

Arm 22

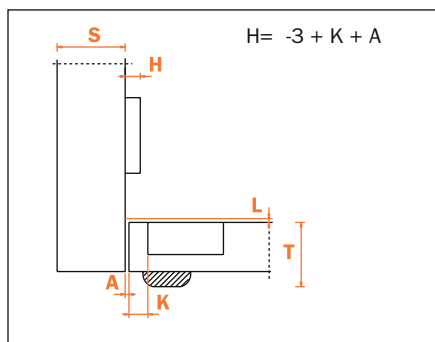

**CA** CF...7P99

**CL** CF...5P99

Use the tables "Drillings and fixings" at page 77 to complete the code number of the desired hinge.

# Series F

## Assembly examples

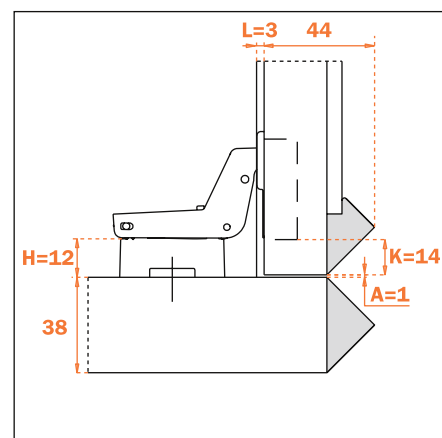
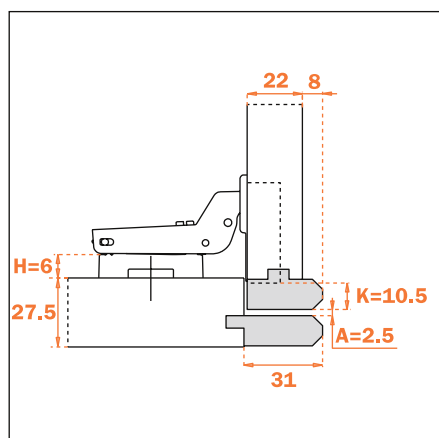
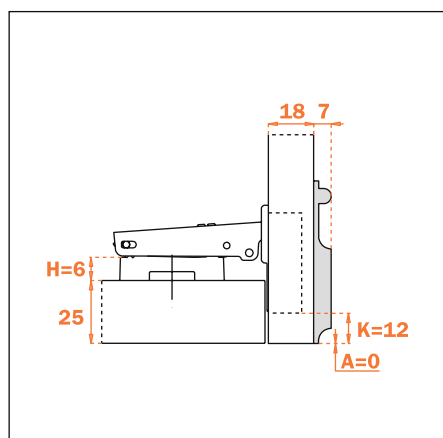
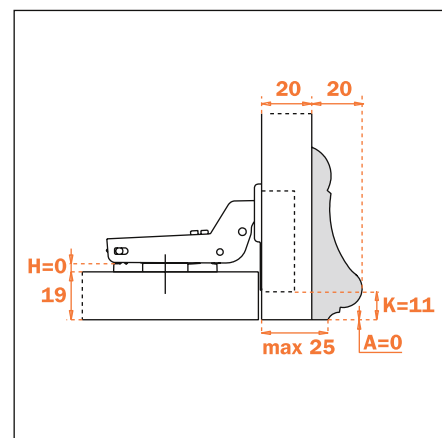
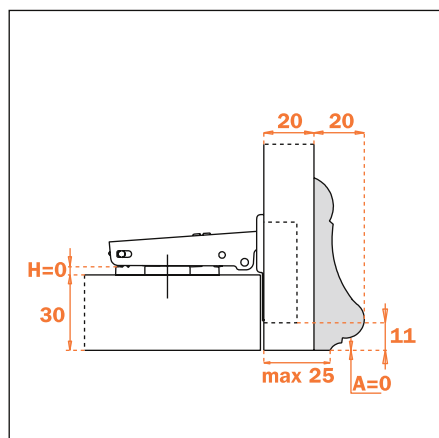
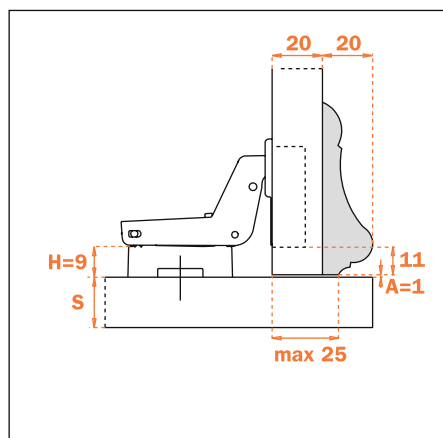
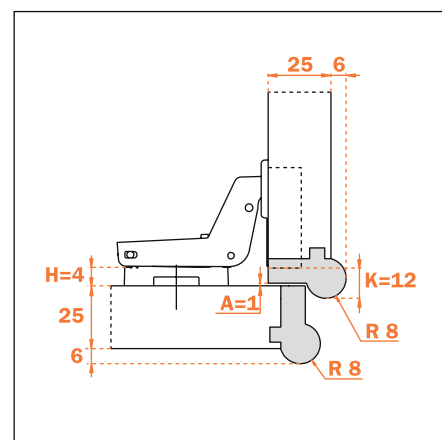
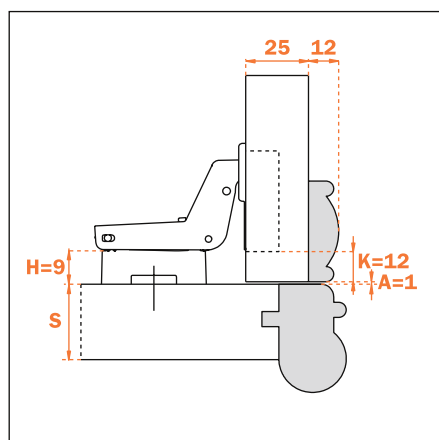
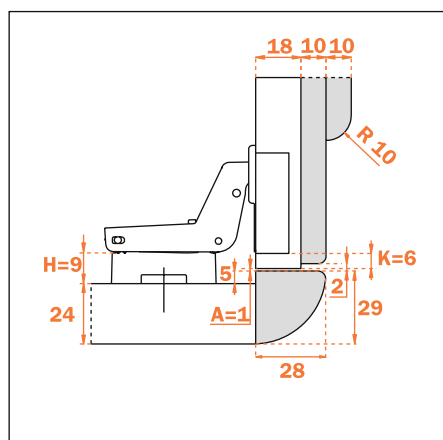
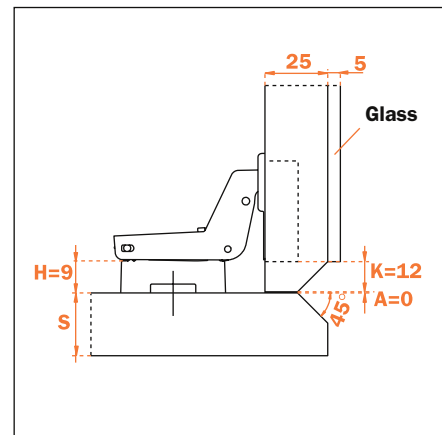
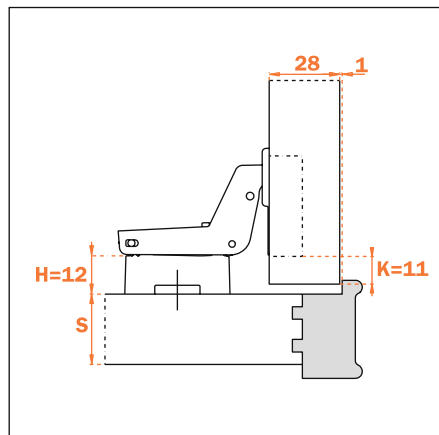
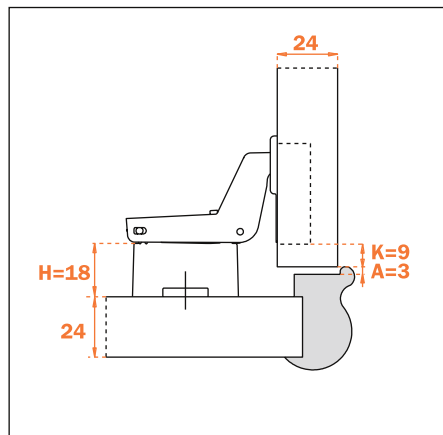

# Series F

## Assembly instructions

### Traditional assembly with Series 200 mounting plates

Place the hinge onto the mounting plate. Push the hinge up to the pre-determined stop under the hinge arm.

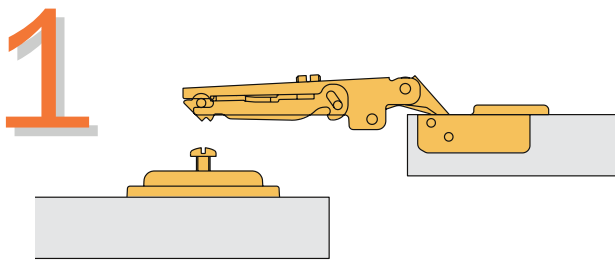

Tighten the fixing screw.

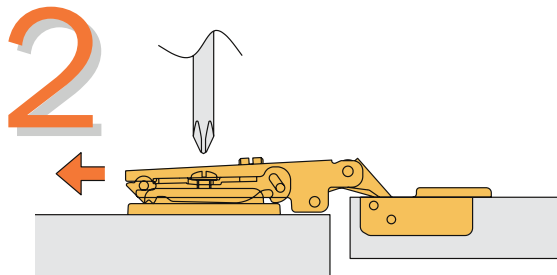

An «L» value of 0,7 mm between door and cabinet side is achieved on final assembly.

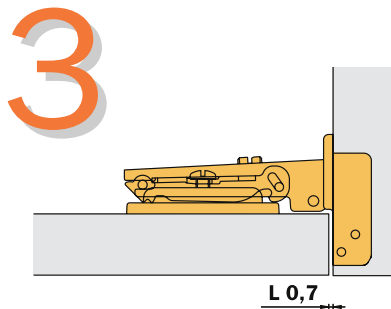

«Key hole» safety feature.

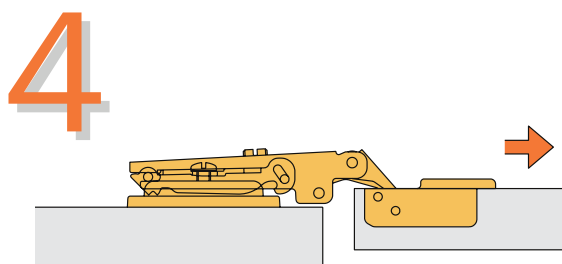

### Assembly with DOMI® snap-on mounting plates

Locate the lugs on the mounting plate into the recesses beneath the arm.

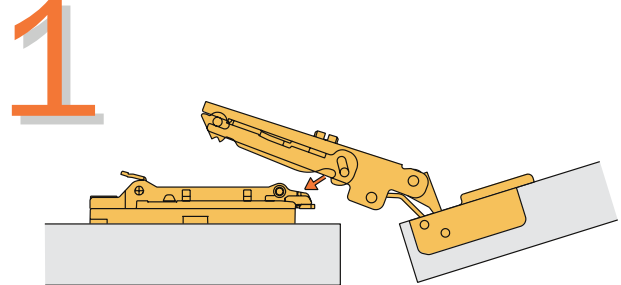

Gently rotate the door in the direction shown.

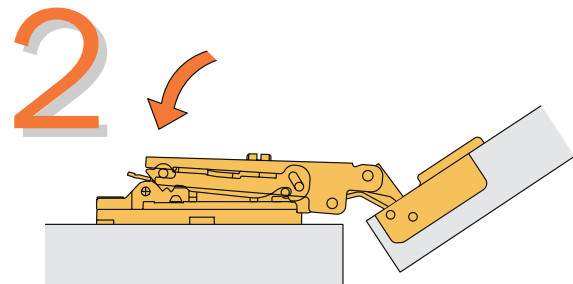

Then press lightly on the end of the arm to secure the catch.

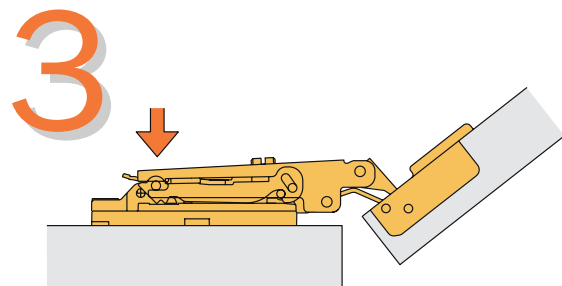

To remove the hinge from the mounting plate, press gently in the places shown by the arrows.

